



FB-300 TABLE BLENDER



YOUR SOLUTION PARTNER



FB-300 TABLE BLENDER

APPLICATION

The FB-300 table blender is used to dissolve solids/powders in recirculated liquids. It has a wide range of applications, for example, preparation of pharmaceutical syrups or dissolution of pectin in glucose for marmelade production. Every model has an option with an in-line mixer for a complete dissolution of possible lumps.

WORKING PRINCIPLE

The suction side and a hopper with a butterfly valve at the upper part to add solids / powders to the pumped liquid. In this blender, the suction and ventury system are set horizontally.

If necessary, an in-line mixer can be installed after the centrifugal pump to reduce the size of possible lumps.

When the valve of the hopper opens, the solids are drawn from the hopper and are totally dissolved when they pass through the casing of the pump.

OPTIONS

- Double mechanical seal.
- Solenoid valve for the seal cooling system.
- Gaskets: FPM or PTFE.
- Connections: DIN, SMS, CLAMP
- Vibrator for hopper.
- Frequency converter for the centrifugal pump.
- Pneumatically actuated valve + lower level sensor for solids.
- Hygienic upper level sensor for solids.
- Control panel for the vibrator, level sensors, frequency converter and automated valve.

MATERIALS

- Parts in contact with the product : AISI 316L
- Other steel parts : AISI 304
- Gaskets in contact with the product : EPDM
- Mechanical seal : SiC/C/EPDM
- Internal and hopper Bright polish Ra : $\leq 0,8\mu\text{m}$



DESIGN AND FEATURES

- Hygienic design.
- ISO 2852 Clamp connections for easy assembly/disassembly.
- Cleaning and disinfection without disassembling the unit.
- Complete mixing with recirculation.
- Manually actuated butterfly valve for hopper.
- Hopper welded to the table with a totally smooth easy-to-clean surface.
- SS control panel with Stop/Start button and motor protection.
- Skid withwheels: 2 rotating + 2 fixed with brakes.
- Triphasic induction motor with B5flange and B3 legs, in compliance with the IEC standards,
- 2 poles = 3000/3600 rpm, efficiency class according to EC regulation,
- IP 55 protection and F-class insulatio

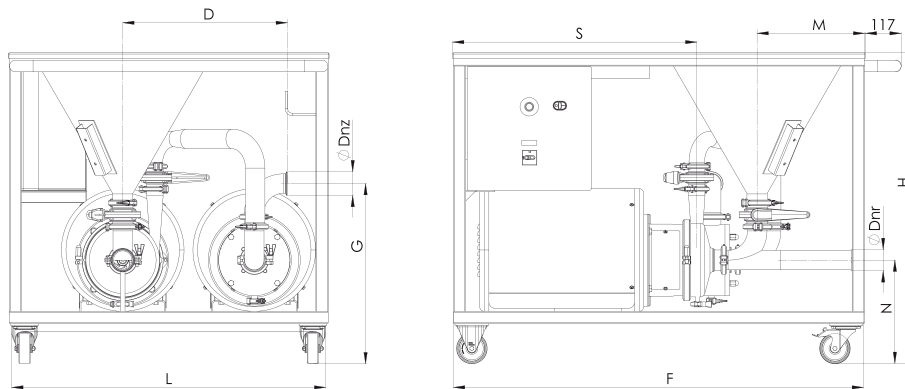

FB-300 Table Blender

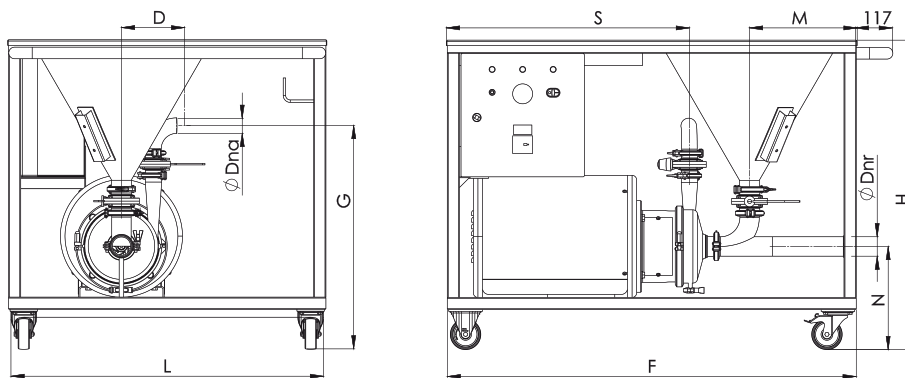

FB-300-M Table Blender

DIMENSIONS

TYPE	Ø DNr	Ø DNa	D	G	S	N	L	F	H	M
FB-300-026	2 1/2"	2"	161	603	649	320	710	1190	1000	353
FB-300-035	2 1/2"	2"	194	660	797	337	740	1340	1014	353
FB-300-038	4"	2"	240	849	1056	470	850	1770	1268	448
FB-300-026-M	2 1/2"	2"	134	564	702	320	970	1190	1000	353
FB-300-035-M	2 1/2"	2"	136	588	844	337	1040	1340	1014	353
FB-300-038-M	4"	3"	181	773	1090	470	1280	1770	1268	448

CAPACITY

Liquid (m ³ /h)	Powder (kg/h)	Power (kw)	Speed (rpm)	Weight (kg)
25	950	4	3000	220
40	3300	7,5	3000	305
95	9200	18,5	3000	650
25	950	4	3000	130
40	3300	7,5	3000	185
95	9200	18,5	3000	355



Marfil Group Sp. Z o.o. spółka komandytowa

Ul. Chełmżyńska 70 04-247 Warsaw / Poland

Mobile: +48 506 197 962 - **Phone:** +48 22 610 19 82

info@flussmann.com - www.flussmann.com